

* Urgent. *



Department of Environment and Conservation – Department of Mines and Petroleum

CPS No.

Application for a clearing permit (purpose permit)

Environmental Protection Act 1986 s 51E

FORM C2

Clearing of native vegetation is prohibited in Western Australia except where a clearing permit has been granted or an exemption applies. A person who causes or allows unauthorised clearing commits an offence.

Date stamp

Part 1 Land details

The location of the land where clearing is proposed must be accurately described.

DEPARTMENT OF ENVIRONMENTAL
REGULATION

FILE REFERENCE

Corporate Information

Land description: Volume and Folio number, Lot or location number(s), Crown Lease or Reserve number, Pastoral Lease number or Mining Tenement number of all properties where clearing is proposed.

Required clearing permit for watercorp
sewer extension along Berkshire Road
and Ashby close - 100m (approx).

Local government area

Shire of Kalamunda.

Part 2 Proposal

An aerial photograph or map with a north arrow must be attached, clearly marking the area proposed to be cleared.
or
If you have the facilities, a digital map on CDROM of the area to clear in one of the following formats:

- ESRI Shapefile with the following properties:
 - Geometry Type: Polygon shape
 - Coordinate System: GCS GDA 1994 (Geographic latitude/longitude)
 - Datum: GDA 1994 (Geocentric Datum of Australia 1994).
- Autocad 2000 or earlier; or
- Microstation 8 or earlier.

Total area of clearing proposed (hectares)

0.01 (< 100 m²)

Proposed method of clearing

Trench to be dig by backhoe.

Period within which clearing is proposed to be undertaken, e.g. May 2010–June 2010

November 2013

Purpose of clearing

To run extension of sewer pipe

Part 3 Applicant

To apply for a permit you must either be:

- the landowner; or
- have the authority of the landowner to access the land and undertake the clearing.

If granted, the permit will be issued in the name of the applicant.

Are you applying as an individual, a company or an incorporated body? – Enter details for one only (please print).

An individual – applicant's given names, Family name and title (Mr, Mrs, Ms, etc)

Ummop Sihanuk

Resource Engineering and design.

A company or incorporated body name (Note: companies must supply an Australian Company Number - ACN)

Ownership of land

- A landowner can be:
- a person who holds the Certificate of Title;
 - a person who is the lessee of Crown land, or
 - a public authority that is responsible for care of the land.

Full name of all landowners as they appear on the Certificate of Title (please print)

(1) N/A.

(2)

If more than one Certificate of Title, please include details on a separate sheet.

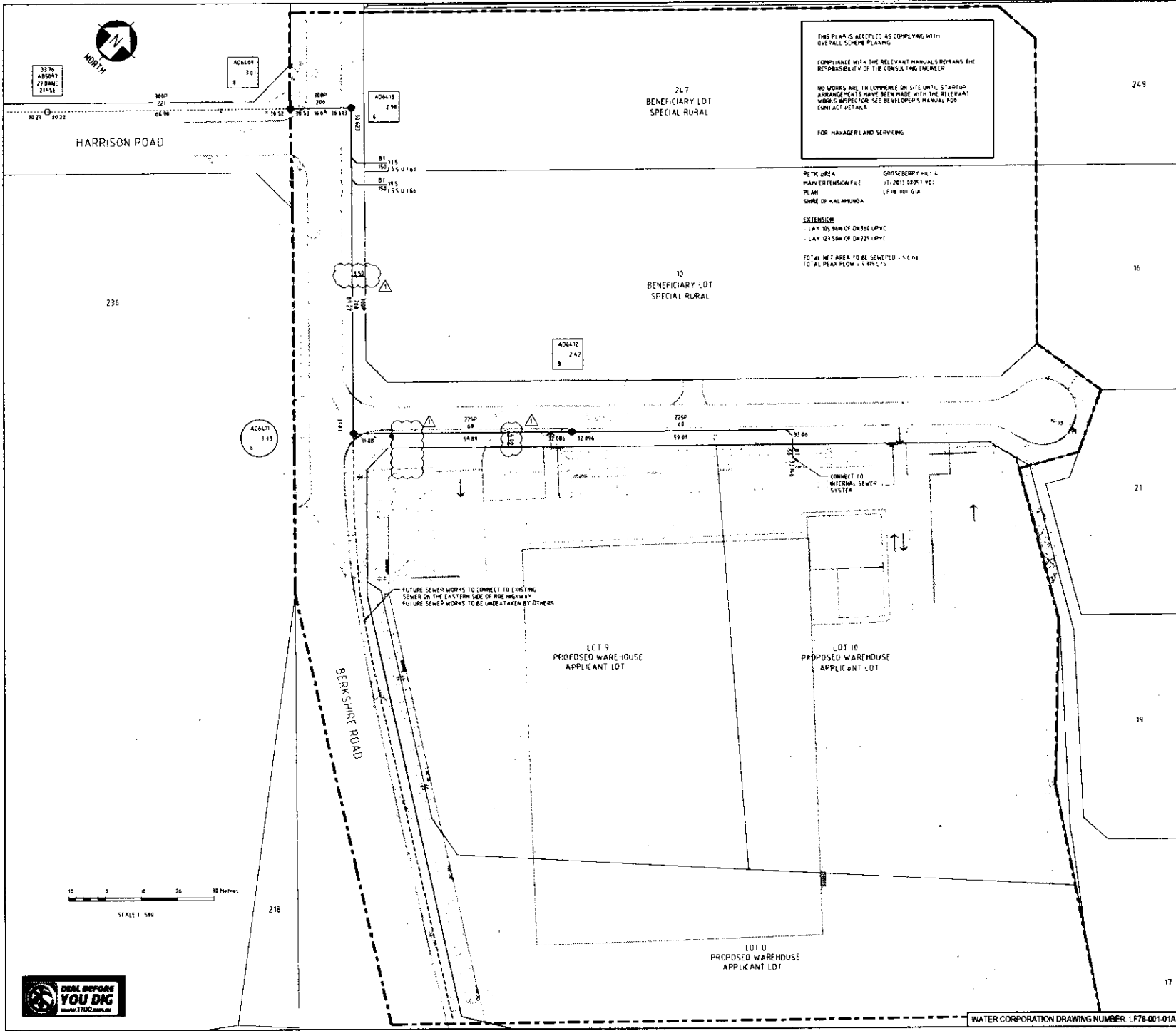

THIS PLAN IS ACCEPTED AS COMPLYING WITH OVERALL SCHEME PLANNING.

COMPLIANCE WITH THE RELEVANT MANUALS DEMANDS THE RESPONSIBILITY OF THE CONSULTING ENGINEER.

NO WORKS ARE TO COMMENCE UNTIL STARTUP ARRANGEMENTS HAVE BEEN MADE WITH THE RELEVANT WORKS INSPECTOR. SEE DEVELOPER'S MANUAL FOR CONTACT DETAILS.

FOR MANAGERLAND SERVICES

RETIC AREA: GOOSEBERRY HILL 4
 MAIN EXTENSION FILE: JT-2012-00051-P0
 PLAN: LF78-001-01A
 SHARE OF KALAMUNDA

EXTENSION:
 LAY 105.5mm OF DN160 UPVC
 LAY 125.5mm OF DN125 UPVC

TOTAL RETIC AREA TO BE SERVED: 1.4 Ha
 TOTAL PEAK FLOW: 1.9 L/s

GENERAL NOTES

- STANDARD NOTES SEE WATERCORP STANDARD AAS1-1-1
- SEWER TRENCH DETAILS SEE WATERCORP STANDARD AAS1-11-1
- GENERAL PLASTIC LINED PRECAST CONCRETE ACCESS CHAMBER DETAIL SEE WATERCORP STANDARD DRAWING:
 AAS1-51-1
 AAS1-51-2
 AAS1-51-4
 AAS1-51-5
 AAS1-51-6
- PIPE INDICATOR AND MARKER TAPE SEE WATERCORP STANDARD AAS1-B1-1
- PROPOSED SEWAGE PIPE TO BE 15m FROM PROPERTY BOUNDARY
- PRIOR TO COMMENCEMENT OF WORKS THE CONTRACTOR SHALL CHECK THE LOCATION OF EXISTING SERVICES AND CONFIRM PROPOSED SEWER ALIGNMENT AND FINISHED SURFACE LEVELS AND INVERT LEVELS OF EXISTING STUBS TO BE INCORPORATED IN THE WORKS

LEGEND

- PROPOSED GRAVITY SEWERS WITH ACCESS CHAMBER/MAINTENANCE SHAFTS
 - EXISTING SEWERS (GRAVITY)
 - RETICULATION AREA BOUNDARY
 - FUTURE SEWER WORKS
 - EXISTING POTABLE WATER LINE
 - EXISTING TELEPHONE LINE
 - EXISTING OVERHEAD POWER LINE
 - EXISTING STORMWATER LINE
- NON-TRAFFICABLE ACCESS CHAMBER OR MAINTENANCE SHAFT**
- CHAMBER / SHAFT NUMBER
 - DEPTH
 - DROP # APPLICABLE
 - CHAMBER TYPE
 6 PLASTIC LINED PRECAST CONCRETE CHAMBER
 8 MAINTENANCE SHAFT
- TRAFFICABLE ACCESS CHAMBER OR MAINTENANCE SHAFT**
- CHAMBER / SHAFT NUMBER
 - DEPTH
 - DROP # APPLICABLE
 - CHAMBER TYPE
 6 PLASTIC LINED PRECAST CONCRETE CHAMBER
 8 MAINTENANCE SHAFT

REV	DATE	BY	REVISION DESCRIPTION
1	20/11/13	BS	ISSUED FOR CONSTRUCTION
0	04/11/13	RS	ISSUED FOR CONSTRUCTION



RED
 Resource Engineering & Design
 BUILDINGS

Level 1, 156 Adelaide Terrace
 East Perth, WA 6004
 Tel: (08) 9427 9588
 Fax: (08) 9427 9589
 admin@redengineering.com.au

PROJECT
 BRT HIGH WYCOMBE
 FORREESTFIELD, WA 6058

DRAWING TITLE
 HYDRALLIC WORKS
 GRAVITY SEWER
 WATERCORP SEWER EXTENSION PLAN

DESIGN	KV	CHECKED	BS
DRAWN	DR	APPROVED	BS
SCALE	1:500	DRAWING NUMBER	REV
PAGE	A1		
PROJECT	DTH-12-088	OTH2088-H-00001	1

GENERAL NOTES: CONTRACTOR TO CHECK ALL DIMENSIONS ON-SITE. REFER ANY DISCREPANCIES TO ARCHITECT FOR A DESIGN PRIOR TO COMMENCING ANY WORK OR PREPARING SHOP DRAWINGS.